

Preferred^{PL}Living[®]

Instruction Manual



Steel Convertible Garden Cart

sku # 10794



Preferred^{PL}Living[®]

Steel Convertible Garden Cart

sku # 10794

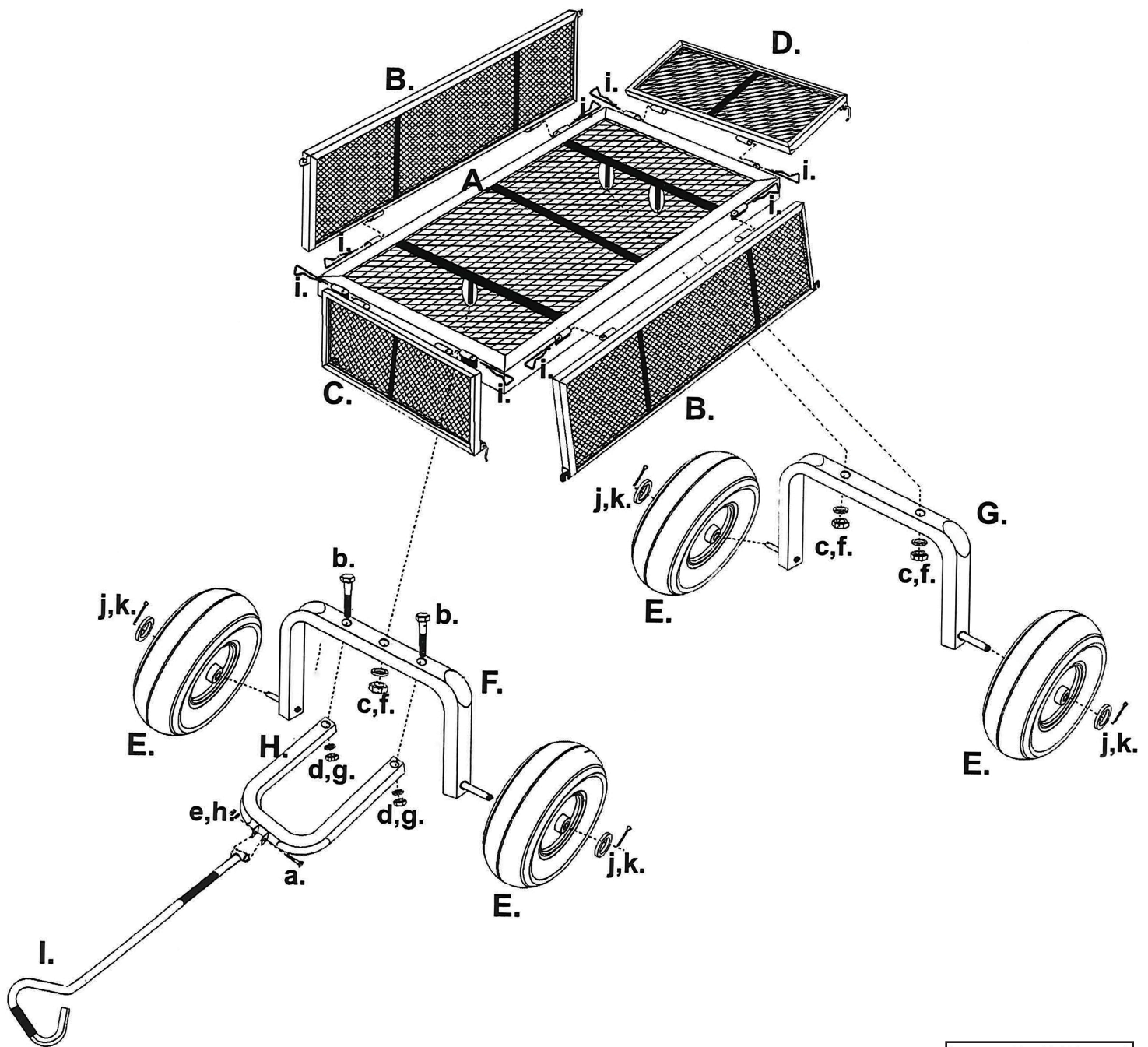

Want some help?

Watch our step-by-step assembly video
by scanning with your phone's camera!



Steel Convertible Garden Cart

sku # 10794

Part List:

- A. Bed (1)
- B. Side Panels (2)
- C. Front Panel (1)
- D. Back Panel (1)
- E. Wheels (4)
- F. Front Axle Support (1)
- G. Rear Axle Support (1)
- H. Yoke (1)
- I. Handle (1)

Hardware List:

- a. M8 x 60 Hex Bolt (1)
- b. M10 x 60 Flat Bolts (2)
- c. M12 Nylon Nuts (3)
- d. M10 Nylon Nuts (2)
- e. M8 Nylon Nut (1)
- f. M12 Flat Washers (3)
- g. M10 Flat Washers (2)
- h. M8 Flat Washer (1)
- i. Fence Assembly Pins (8)
- j. M16 Flat Washers (4)
- k. Cotter Pins (4)

a. (1)

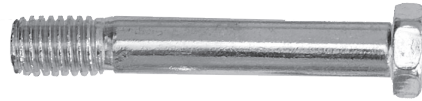

b. (2)

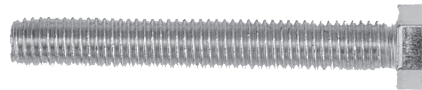

c. (3)



d. (2)



e. (1)



f. (3)



g. (2)



h. (1)



i. (8)

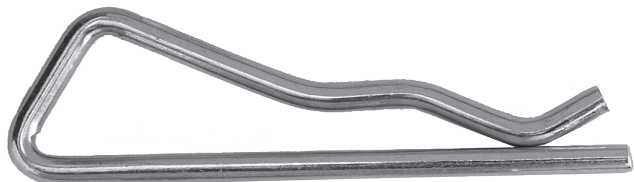

j. (4)



k. (4)



Want some help?

Watch our step-by-step assembly video
by scanning with your phone's camera!



Steel Convertible Garden Cart

sku # 10794

Before You Begin

- Assemble on a flat surface.
- Do not fully tighten hardware until instructed.
- Tools needed: Adjustable wrench and pliers.

Step-by-Step Assembly Instructions

Step 1: Assemble the Cart Bed

1. Place the **Bed (A)** upside down on a flat surface.
2. Attach the **Side Panels (B)** to each side of the bed using **Fence Assembly Pins (i)**.
3. Attach the **Front Panel (C)** and **Back Panel (D)** to complete the cart frame using remaining **Fence Assembly Pins (i)**.
4. Ensure all panels are fully seated and square.

Step 2: Install the Axle Supports

1. Attach the **Front Axle Support (F)** to the underside of the bed using:
 - **M12 Nylon Nuts (c)**
 - **M12 Flat Washers (f)**
2. Attach the **Rear Axle Support (G)** the same way.
3. Leave hardware slightly loose until wheels are installed.

Step 3: Install Wheels

1. Slide one **Wheel (E)** onto each axle end.
2. Secure each wheel using:
 - **M16 Flat Washer (j)**
 - **Cotter Pin (k)**
3. Bend cotter pins outward to lock wheels in place.

Instructions continued on next page...

Want some help?

Watch our step-by-step assembly video
by scanning with your phone's camera!



Steel Convertible Garden Cart

Instruction Manual

sku # 10794

Step 4: Attach the Yoke and Handle

1. Attach the **Yoke (H)** to the front axle support using:
 - M10 x 60 Flat Bolts (b)
 - M10 Flat Washers (g)
 - M10 Nylon Nuts (d)
2. Attach the **Handle (I)** to the yoke using:
 - M8 x 60 Hex Bolt (a)
 - M8 Flat Washer (h)
 - M8 Nylon Nut (e)

Step 5: Final Tightening

1. Turn the cart upright.
2. Fully tighten all nuts and bolts.
3. Check that wheels spin freely and panels are secure.

Assembly Complete

Your garden cart is now ready for use.

Tip: Periodically check hardware for tightness during regular use.

Need Help?

Scan the QR code below with your phone's camera to watch our **step-by-step assembly video**.

Want some help?
Watch our step-by-step assembly video
by scanning with your phone's camera!

